

# Preliminary Traffic Management Plan

## Albury Wodonga Regional Hospital Project

### Northeast Building

This document has been produced for the Review of Environmental Factors.

## Traffic Management Plan for Northeast Building and Northwest carpark

Proposed preliminary traffic management plan for northwest carpark.

**HANSEN YUNCKEN**  
**KEENE ST ENTRANCE**  
**EAST ALBURY**  
**TGS #180625-1**

**NORTH WEST TEMPORARY  
 CARPARK (INTERNAL)**

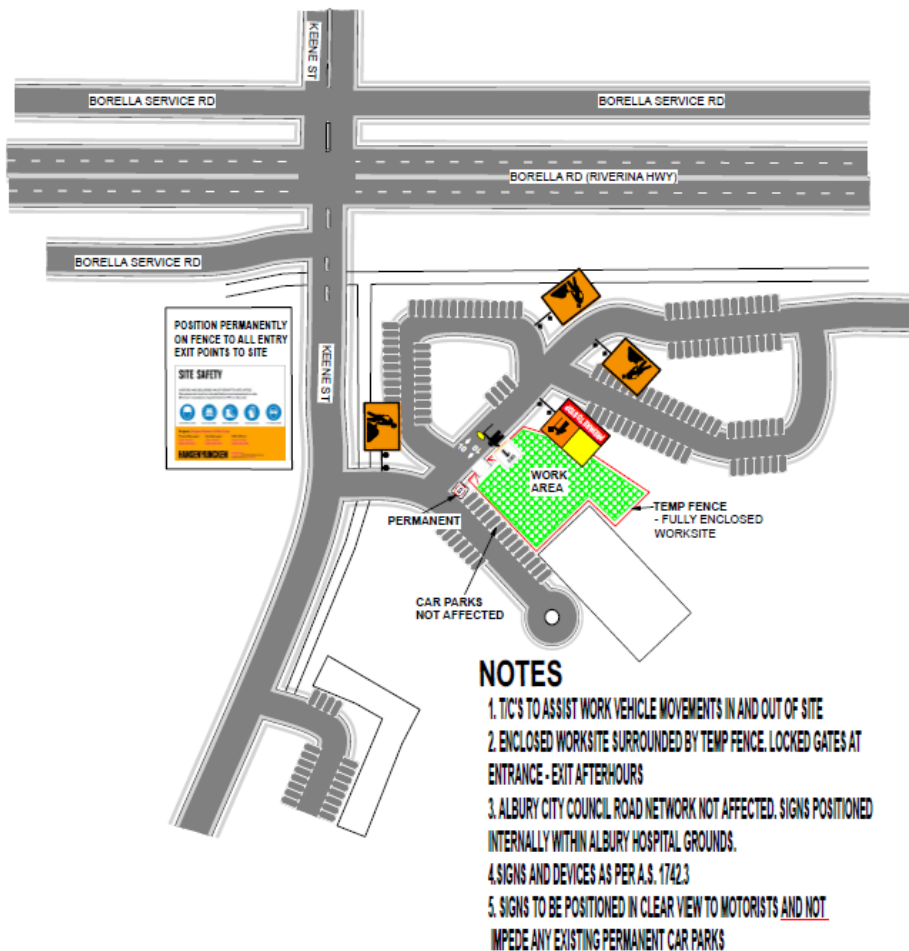

Proposed preliminary traffic management plan for Northeast building

**HANSEN YUNCKEN**  
**EAST ST ENTRANCE**  
**EAST ALBURY**  
**TGS #180625-5**

**NTH EAST  
 BUILDING**

**DRAFT ONLY**

